

DA-FM4600 INSTALLATION MANUAL

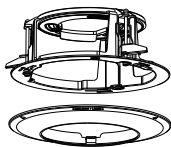

This manual is intended for the users of the DA-FM4600 ceiling mounting bracket. It includes the instructions for mounting the DA-FM4600 ceiling mounting bracket to the ceiling.



- **This bracket is intended to be used with DC-S6261X(-A) model. Ask your retailer for details on a specific model and do not use it with other models of cameras.**
- **This installation should be performed by a qualified service personnel in conformance to all local codes.**
- **You may need to reinforce the ceiling. If the ceiling is not strong enough to support the camera, the camera may fall.**
- **Do not use this product for other purposes.**

Mounting

- 1 Make a hole in the ceiling using the provided guide pattern. Connect the cable through the cable hole.

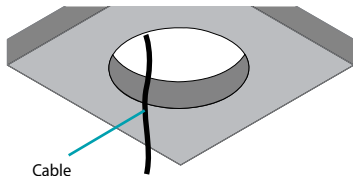

- 2 Mount the bracket to the ceiling, then fix it with the clamp (3-point) by turning the clamp screws clockwise.



Insert with the clamp wing folded.

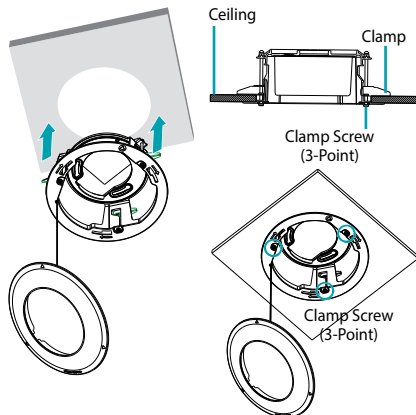
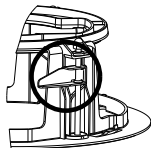

- 3 Connect the network cable and the power adapter. Attach the camera to the install mount. Turn the camera clockwise to fasten.

- Hook the safety wire of the install mount on the safety wire ring of the camera if needed.

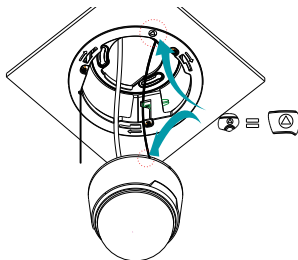

- Push and rotate it counterclockwise when disassembling the product.

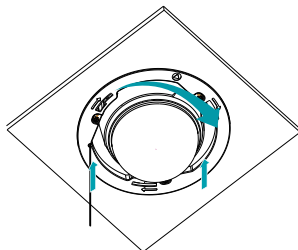

- 4 Attach the DA-FM4600 top cover to the bottom cover. Turn the top cover clockwise to fasten.

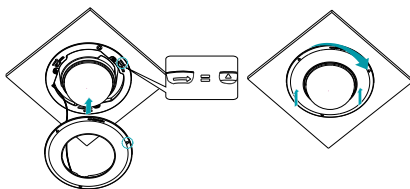

Dimensions

Unit: mm (inch)

